

Gripper

MF16-S,M,L

Character

- Normal closing gripper by spring
- High repeatability & long life by jaw united cross roller
- Twisted it is strong hardness plunger
- For precise positioning of individual gripping jaw



Mechanical type

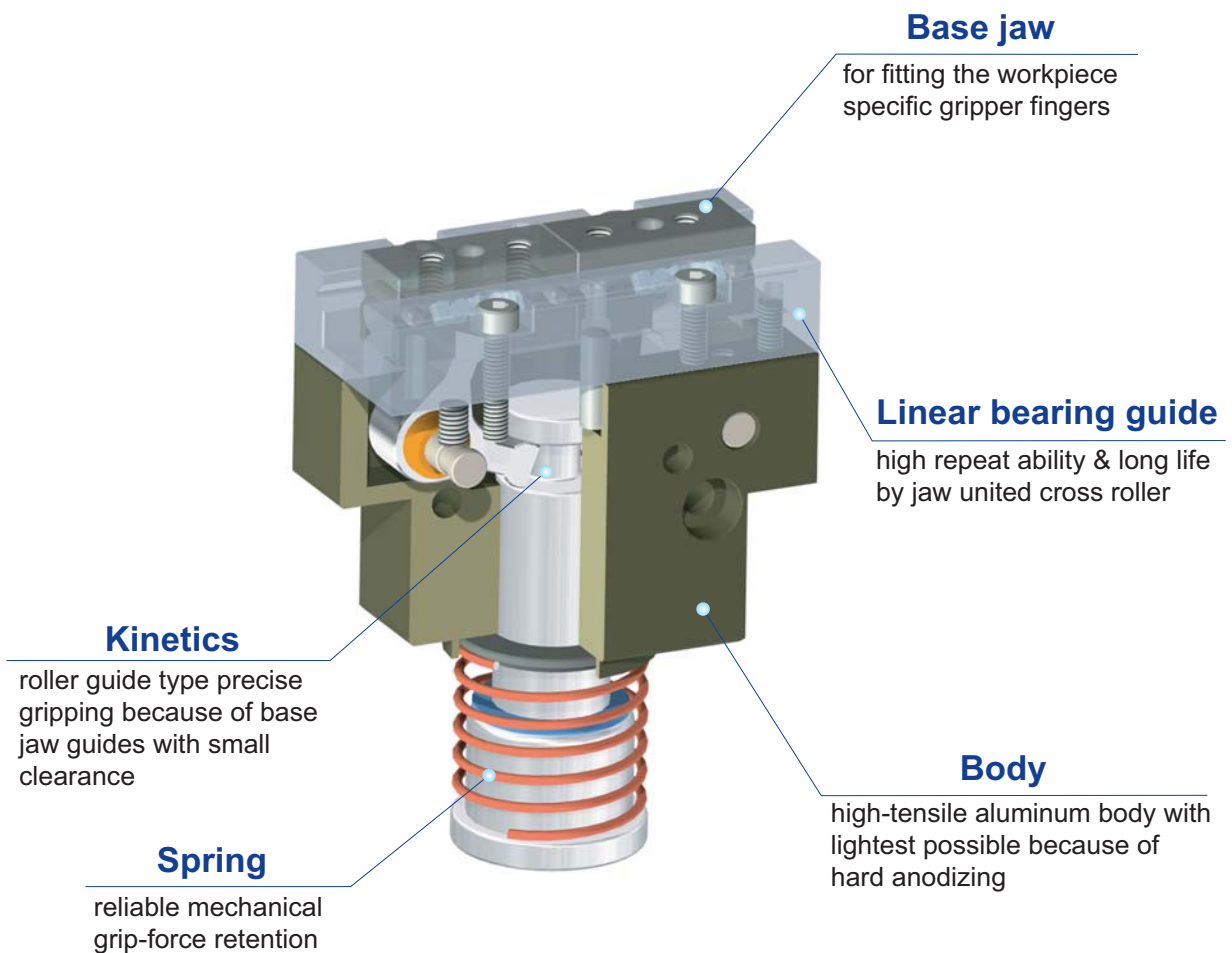

MF16

Exploded view

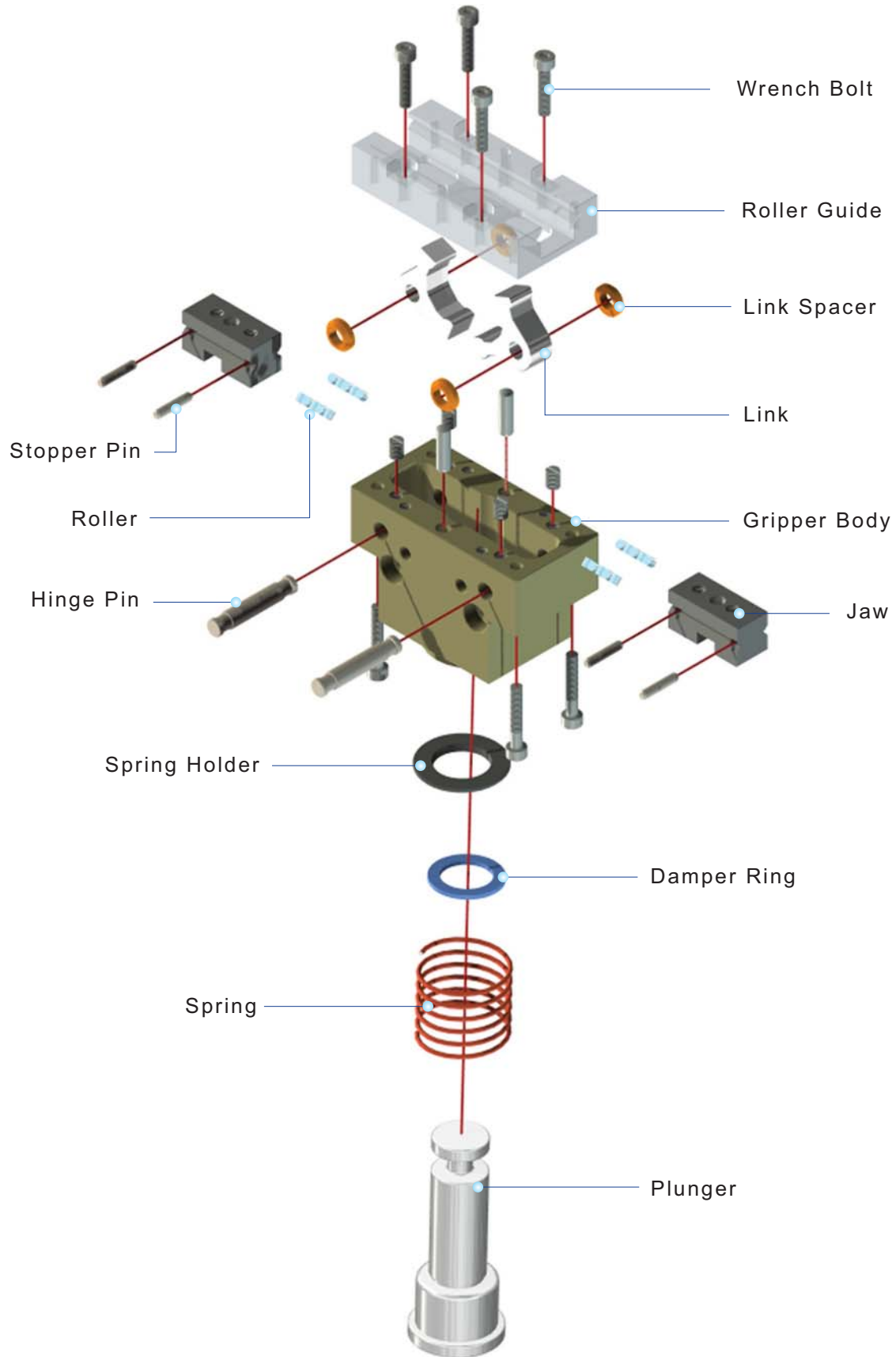

MF16

Ordering Code

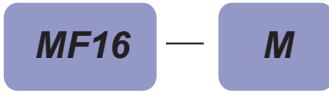

①

②

| | | |
|---|--------------|---------|
| ① | Product Name | MF16 |
| ② | Size | S, M, L |

Specification

| Product name | MF16-S | MF16-M | MF16-L | Unit |
|-----------------------|----------|----------|----------|------|
| Stroke | 12 | 14 | 16 | mm |
| Weight | 0.2 | 0.34 | 0.5 | kg |
| Max. length of attach | 32 | 40 | 60 | mm |
| Gripping force:Close | 10 to 20 | 15 to 30 | 25 to 40 | N |
| Max.cycle per minute | 60 | 50 | 40 | |
| Ambient temperature | -5 to 60 | | | °C |
| Lubrication | Needless | | | |

MF16

MF16-S

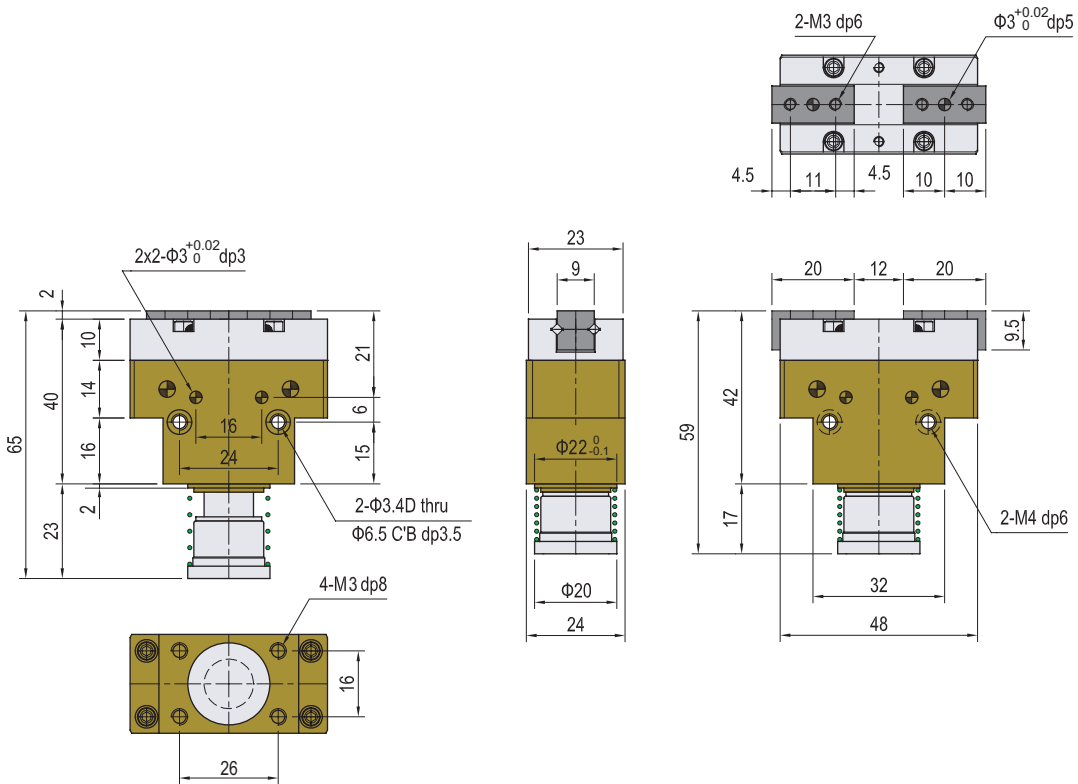

MF16-M

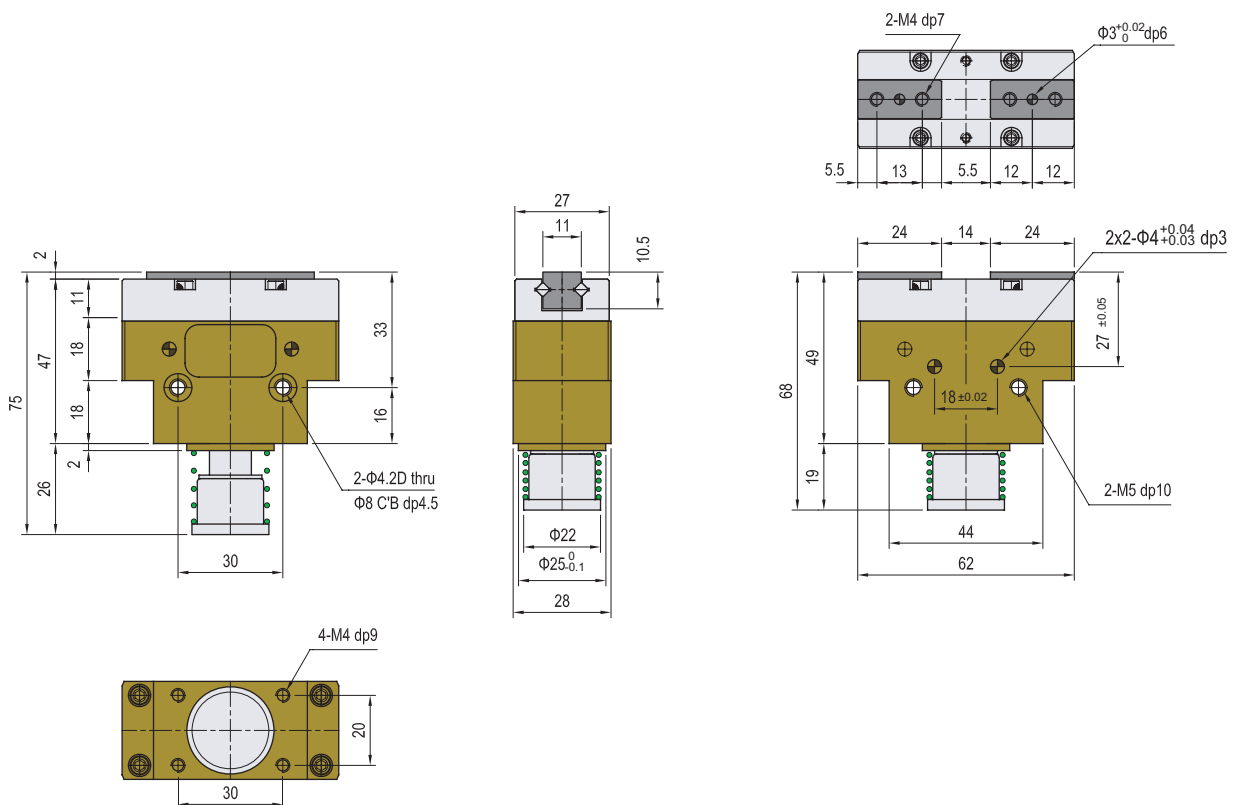

MF16

MF16-L

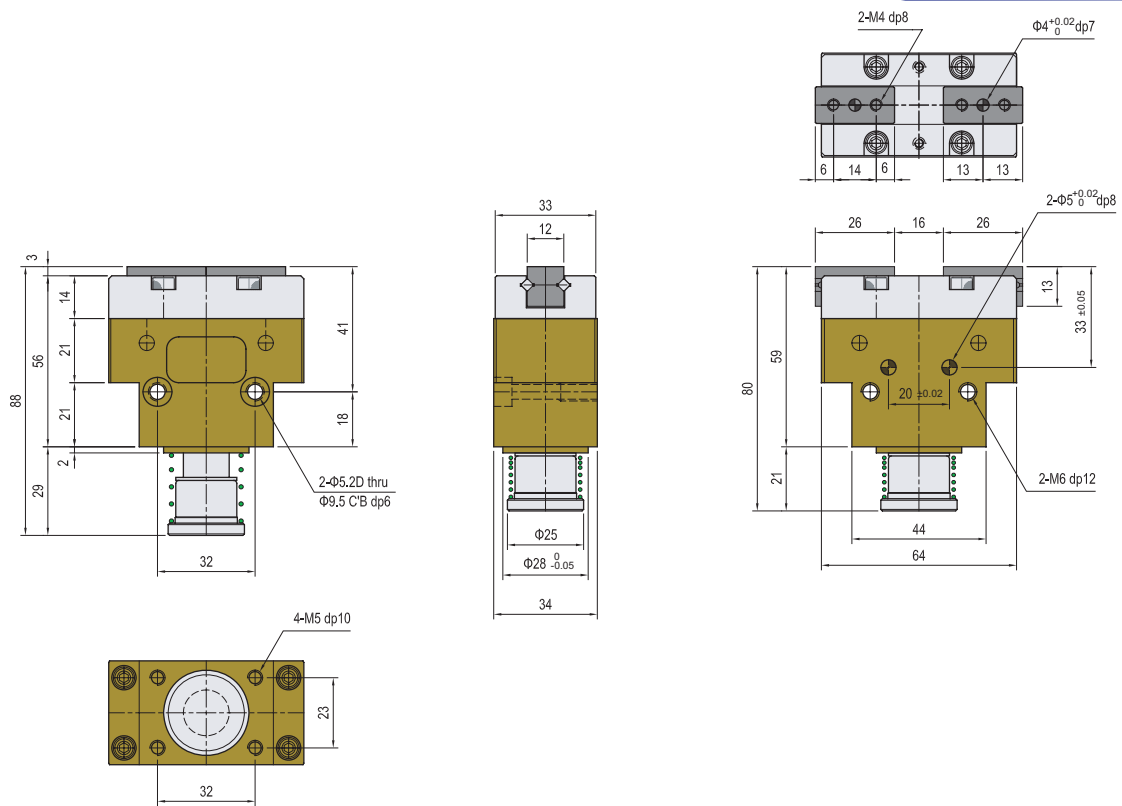

Note